

# x1R Easy Keypad Reader

**ISEO** Zero1  
ELECTRONIC  
SOLUTIONS

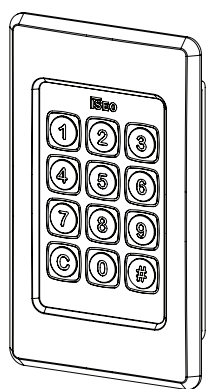

**ISEO**  
iseo.com

Iseo Serrature s.p.a  
Via San Girolamo 13  
25055 Pisogne (BS)  
ITALY  
Tel. +39 0364 8821  
iseo@iseo.com

Download  
User Manual



iseo.com

**ELECTRONIC SUPPORT SERVICE**  
iseozero1.com

800-728722  
numero verde gratuito

Non contractual document. Subject to change. Cod. 600000PE02698 - 20200207  
x1R Easy Keypad Reader Installation Guide (EN) - © 2020 Iseo Serrature S.p.a. - www.iseo.com

## WARNINGS



- Read this manual prior to use the device in order to ensure a safe and proper use.
- Preserve this manual as future reference.
- The installation and maintenance of the device must be carried out by qualified technical staff, adequately trained by ISEO.
- The instructions should be carefully followed during installation. These instructions and any maintenance instructions should be passed on by the installer to the user.
- No modifications of any kind are permitted, except for those described in these instructions.
- The product must be destined only for the use for which it is expressly designed and therefore as a keypad reader for civil and industrial locations. Any other use is considered improper and dangerous.
- The electrical connection must be made according to the constructor's instructions and respecting the regulations in force.
- Disconnect the power supply before carrying out any technical service that involves opening or accessing the internal parts of the product. For all repairs, exclusively contact a technical assistance center authorized by the constructor.
- RFID antenna 125Khz.
- Operating and storage temperature: -20°C/+70°C with Relative Humidity Max. 95% without condensing.
- IP44 (related to product installed in the door).



<https://www.iseo.com/it/en/download>

## 1. COMPONENTS

Keypad  
Reader



Fixing  
screws

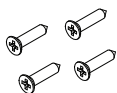

Cover

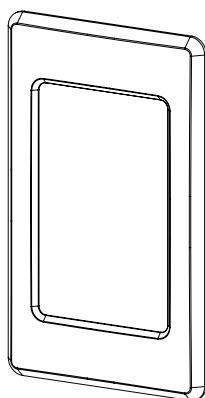

Cover can be provided in different finishes and needs to be separately ordered. For the product codes refer to the catalogue available at [iseo.com](http://iseo.com).



Connection cable not included in the kit. It is supplied in the x1R Easy packaging.

## 2. DIMENSIONS

UM = mm

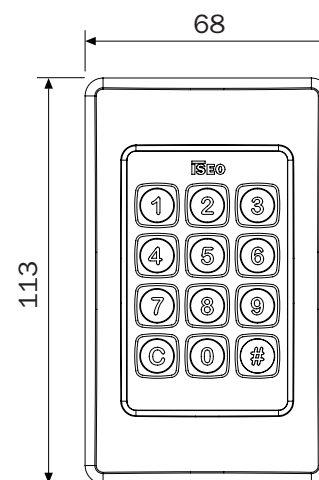
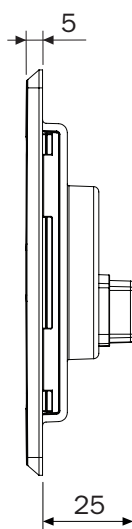

## 3. INSTALLATION EXAMPLE

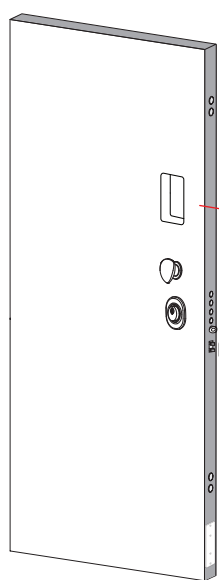

1

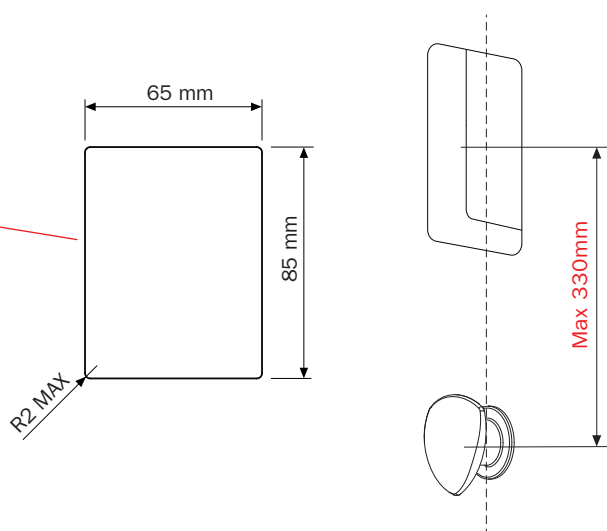

Be careful to respect the reader exact hole measures, in order to leave enough space on the sides to properly fix the keypad screws.

### 3.1 INSTALLATION EXAMPLE

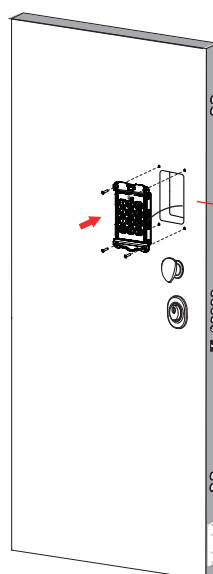

2

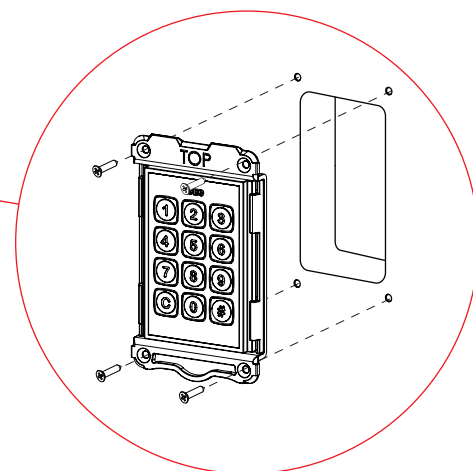

### 3.2 INSTALLATION EXAMPLE

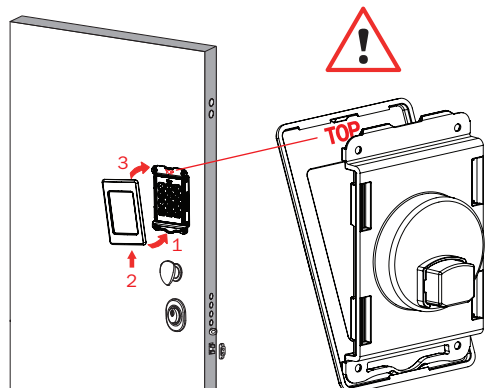

3

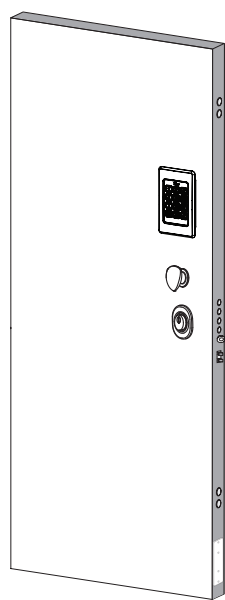

4

## 4. ELECTRICAL CONNECTION

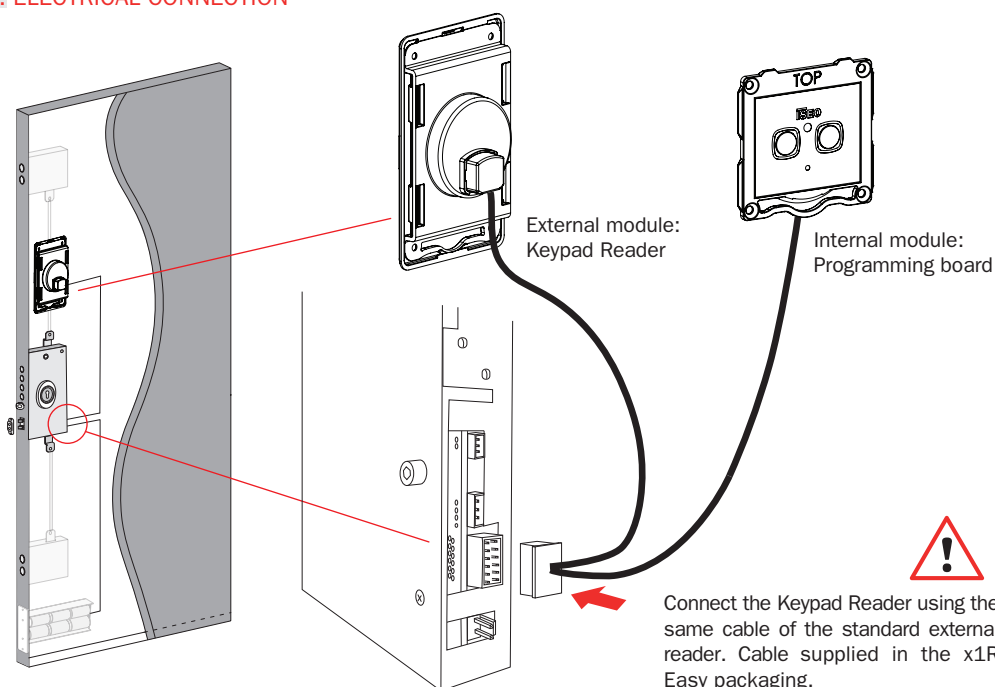

Connect the Keypad Reader using the same cable of the standard external reader. Cable supplied in the x1R Easy packaging.

# x1R Easy

## Tastiera con lettore

**ISEO** Zero1  
ELECTRONIC  
SOLUTIONS

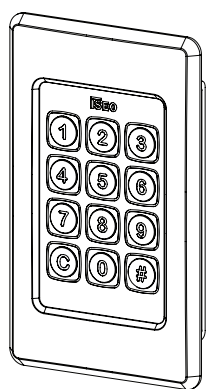

**ISEO**  
iseo.com

Iseo Serrature s.p.a  
Via San Girolamo 13  
25055 Pisogne (BS)  
ITALY  
Tel. +39 0364 8821  
iseo@iseo.com

Download  
User Manual



iseo.com

**ELECTRONIC SUPPORT SERVICE**  
iseozero1.com

800-728722  
numero verde gratuito

Documento non contrattuale. Soggetto a modifica. Cod. 600000PE02698 - 20200207  
Guida Installazione x1R Easy Tastiera con lettore (IT) - © 2020 Iseo Serrature S.p.a. - www.iseo.com

### AVVERTENZE



  **ISEO**  
<https://www.iseo.com/it/it/download>

- Leggere il manuale utente prima dell'utilizzo del prodotto al fine di garantire un uso sicuro e corretto.
- Conserva questo manuale come riferimento futuro.
- L'installazione e la manutenzione del prodotto devono essere effettuate da personale tecnico qualificato, adeguatamente addestrato da ISEO.
- Le istruzioni devono essere seguite attentamente durante l'installazione. L'installatore deve fornire all'utente queste istruzioni ed eventuali istruzioni per la manutenzione.
- Nessuna modifica di alcun tipo è consentita, ad eccezione di quelle descritte in queste istruzioni.
- Il prodotto dovrà essere destinato solo all'uso per il quale è stato espressamente concepito e cioè come lettore di impronte digitali per ambiente civile e industriale. Ogni altro uso è da considerarsi improprio e pericoloso.
- I collegamenti elettrici devono essere fatti secondo le istruzioni del costruttore e nel rispetto delle normative vigenti.
- Scollegare l'alimentazione prima di eseguire qualsiasi intervento tecnico che comporti l'apertura o l'accesso alle parti interne del prodotto. Per le riparazioni, rivolgersi esclusivamente a un centro di assistenza tecnica autorizzato dal costruttore.
- Antenna RFID 125Khz.
- Temperatura di funzionamento e immagazzinamento: -20°C/+70°C con Umidità Relativa Max. 95% senza condensa.
- IP44 (riferito al prodotto installato sulla porta).

### 1. COMPONENTI

Tastiera  
con lettore



Viti di  
fissaggio

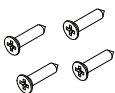

Mostrina

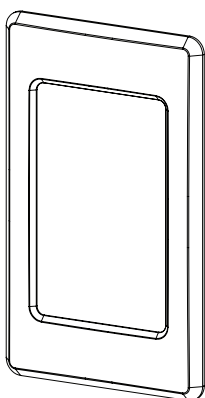

Le mostrine sono disponibili in diverse finiture ed è necessario ordinarle separatamente. Per i codici prodotto fare riferimento al catalogo al sito [iseo.com](http://iseo.com).



Cavo di collegamento non incluso nel kit. Viene fornito nella confezione dell'x1R Easy.

### 2. DIMENSIONI

UM = mm

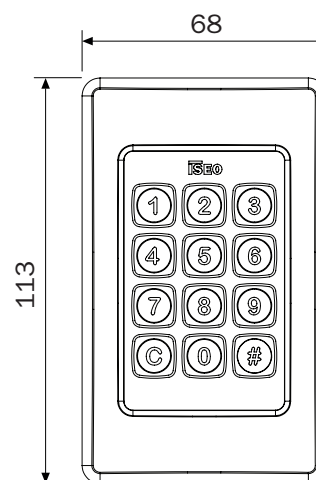
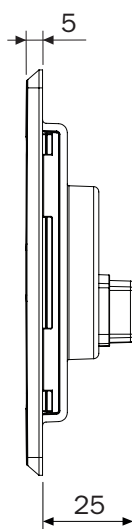

### 3. ESEMPIO DI INSTALLAZIONE

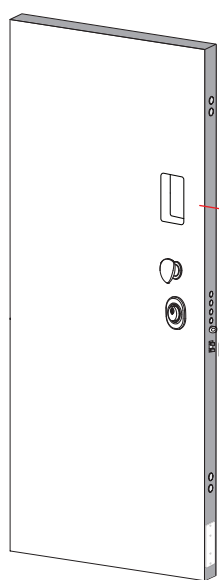

1

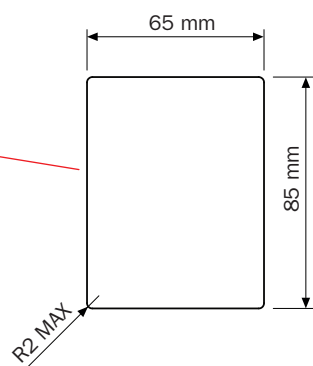

R2 MAX

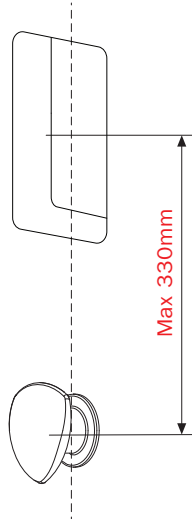

Max 330mm



Prestare attenzione a rispettare le misure del foro in modo da lasciare sufficiente spazio ai lati per applicare le viti fissaggio lettore.

#### 3.1 ESEMPIO DI INSTALLAZIONE

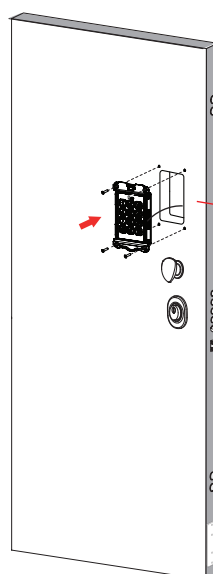

2

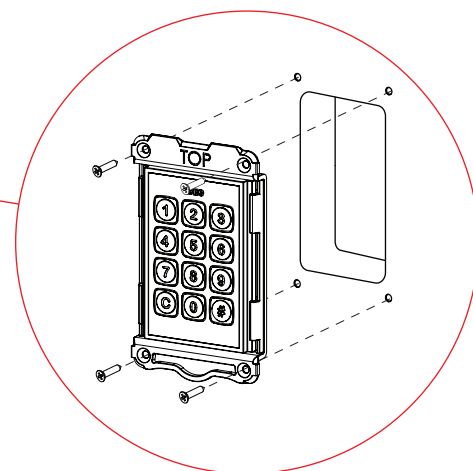

#### 3.2 ESEMPIO DI INSTALLAZIONE

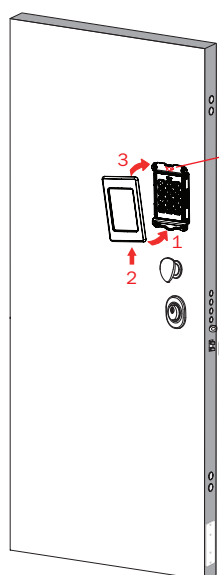

3

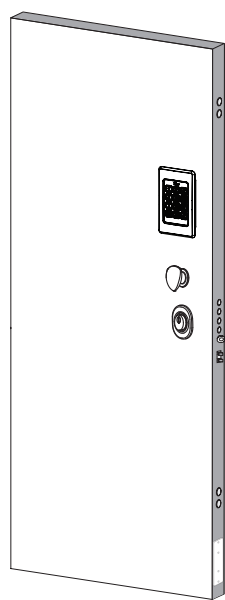
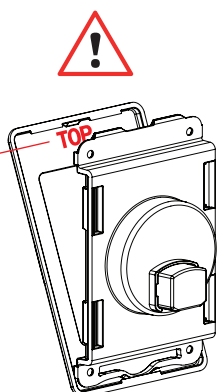

4

### 4. COLLEGAMENTI ELETTRICI

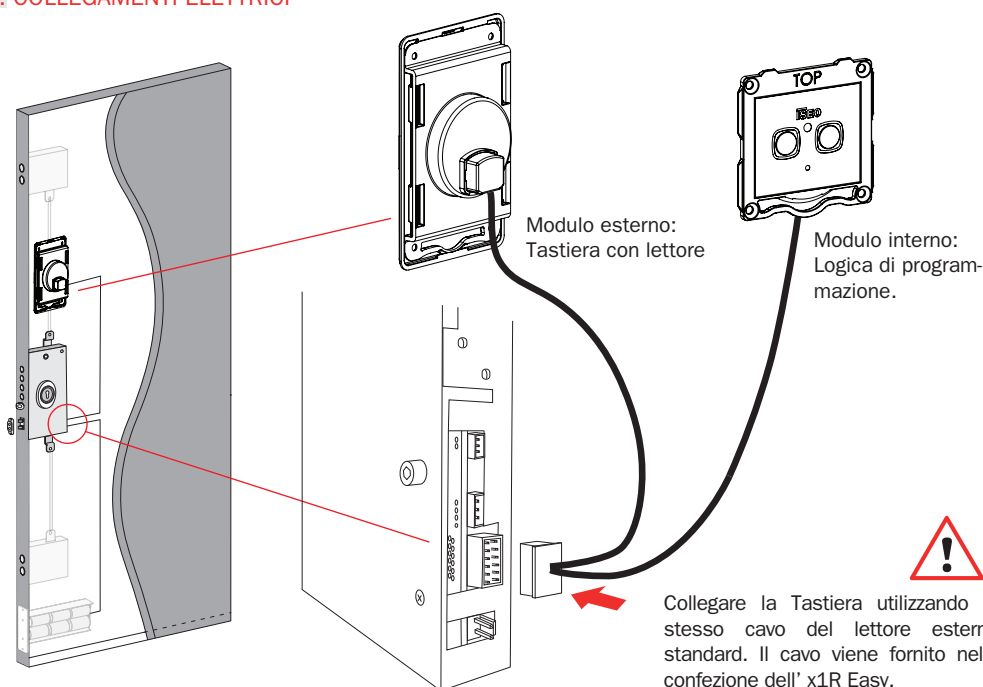

Collegare la Tastiera utilizzando lo stesso cavo del lettore esterno standard. Il cavo viene fornito nella confezione dell' x1R Easy.